

Phone: 1-800-336-7684

Fax: 704-882-0751

www.r82.com

PO Box 1739 Matthews, NC 28106

Account No. \_\_\_\_\_ Drop Ship: \_\_\_\_\_  
 Date: \_\_\_\_\_ Name \_\_\_\_\_  
 P.O. Number: \_\_\_\_\_ Address \_\_\_\_\_  
 Buyer: \_\_\_\_\_ City \_\_\_\_\_  
 Marked For: \_\_\_\_\_ State \_\_\_\_\_ Zip \_\_\_\_\_  
 E Mail: \_\_\_\_\_ Tel. \_\_\_\_\_ Fax \_\_\_\_\_

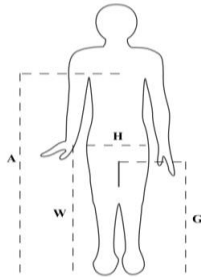

**Key measurements when ordering a Gator**

A (Axilla to Floor Height) \_\_\_\_\_  
 N (Wrist to Floor Height) \_\_\_\_\_  
 D (Hip Width) \_\_\_\_\_  
 G (Groin to Floor Height) \_\_\_\_\_

**Features included in standard price**

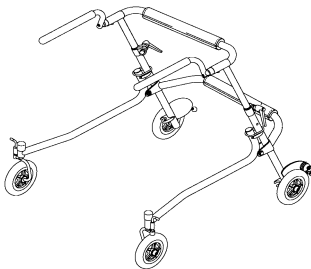

Width and Height Adjustable Rotational Handles  
 Choice of hand grips  
 On/Off Anti-Reverse wheel stops  
 Easy to fold durable steel frame  
 Swivel front castors with castor pin locks  
 Four large 6" x 1 1/4 tires  
 Padded rear stabilizer bar with tool kit

**Gator Complete**

**HCPCS E8001**

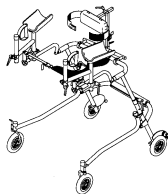

Gator, Yellow, complete w/small accessories*	4500-S-13	<input type="checkbox"/>
Gator, Blue, complete w/small accessories*	4500-S-14	<input type="checkbox"/>
Gator, Red, complete w/small accessories*	4500-S-15	<input type="checkbox"/>
Gator, Yellow, complete w/large accessories*	4500-L-13	<input type="checkbox"/>
Gator, Blue, complete w/large accessories*	4500-L-14	<input type="checkbox"/>
Gator, Red, complete w/large accessories*	4500-L-15	<input type="checkbox"/>



\*Includes: Forearm supports, pelvic pad, lateral pads, lateral strap, anti-tips, sling seat with receiver, and ankle prompts

**Basic Gator Gait Trainer**

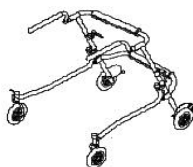
**HCPCS E8000**

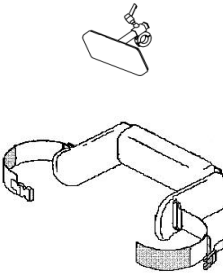
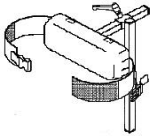
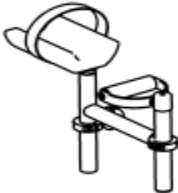
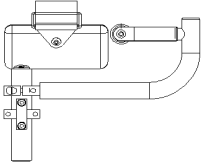
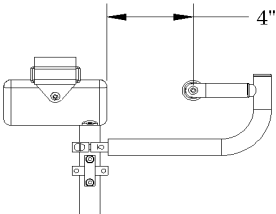
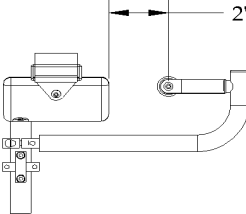
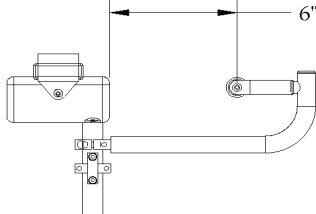

Gator, Yellow, with "no-slip" comfort grip	4100-13	<input type="checkbox"/>
Gator, Blue, with "no-slip" comfort grip	4100-14	<input type="checkbox"/>
Gator, Red, with "no-slip" comfort grip	4100-15	<input type="checkbox"/>
Gator, Yellow, with "hand-stop" bike grip	4110-13	<input type="checkbox"/>
Gator, Blue, with "hand-stop" bike grip	4110-14	<input type="checkbox"/>
Gator, Red, with "hand-stop" bike grip	4110-15	<input type="checkbox"/>

	Description	Size	Part No.	
<b>Accessories</b>				
	Pelvic pad, Small (Without lateral pads)	7" w x 3½" h	4010	<input type="checkbox"/>
	Pelvic pad, Large (Without lateral pads)	9" w x 3½" h	4011	<input type="checkbox"/>
	Pelvic strap - attaches to pelvic pad	one size	4012	<input type="checkbox"/>
	Lateral pads (must include Pelvic pad above)	5" d x 3½" h	4015	<input type="checkbox"/>
	Width - small adjusts from 6" to 9"... large 8" to 11½"			
	Lateral strap (Attaches to lateral pads)	one size	4016	<input type="checkbox"/>
<i>Pictogram to left shows Pelvic pad combined with Lateral pads and Lateral strap</i>				
	Back prompt (Requires anti-tips & receiver)	one size	4020	<input type="checkbox"/>
	Strap for back prompt	one size	4012	<input type="checkbox"/>
	Receiver for back prompt	one size	4605	<input type="checkbox"/>
<hr/>				
	Sling Seat	one size	4055	<input type="checkbox"/>
<hr/>				
	Forearm support, right, 5½" pad length	size 1	4800-R	<input type="checkbox"/>
	Forearm support, left, 5½" pad length	size 1	4800-L	<input type="checkbox"/>
	Forearm support, right, 8½" pad length	size 2	4850-R	<input type="checkbox"/>
	Forearm support, left, 8½" pad length	size 2	4850-L	<input type="checkbox"/>
	Wrist Cuff for Gator Forearm Supports, set	size 1 & 2	4065	<input type="checkbox"/>
<b>Forearm Support Measurements - Gator</b>				
				
Size 1 - Min.	Size 1 - Max.	Size 2 - Min.	Size 2 - Max.	
	Anti-tip bars	one size	4060	<input type="checkbox"/>
	<hr/>			
	Ankle prompts, pair	one size	4095	<input type="checkbox"/>
<hr/>				
	Back pack	one size	86839	<input type="checkbox"/>
<hr/>				
	Attendant Handle	one size	36-4050	<input type="checkbox"/>

---

**Measurements**

---

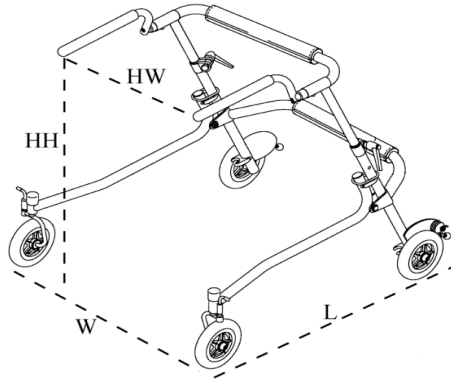

Overall Length (L)	27½"
Overall Width (W)	23"
Handle Height Minimum to Maximum - Wrist to Floor (HH)	13½" - 27"
Handle Width Minimum to Maximum (HW)	10" - 18"
Length, Folded	42"
Height, Folded	12"
Small Pelvic Pad (Width - Height)	7" - 3½"
Large Pelvic Pad (Width - Height)	9" - 3½"
Back Prompt Height (Minimum to Maximum)	24" - 36"
Back Pad Size (Width - Height)	8½" - 4½"
Weight of Basic Unit	14 lbs.
Weight of Complete Unit	22 lbs.
Maximum User Height	45"
Maximum User Weight	75 bs.

---

**NOTES**