

R82 Cricket - E1236

Order Form



Account #: _____ Purchase Order No.: _____ Date: _____
 Contact: _____ Mark For: _____

Bill To:	Ship To:
Address:	Address:
City/State/Zip:	
Phone:	City/State/Zip:
Email	Phone:

US Configuration

Effective: 05.08.19 - Rev 4

- ☐ Cricket
- ☐ Cushion
- ☐ Arm rests
- ☐ Head support
- ☐ Tray
- ☐ Grip bar
- ☐ Folding top
- ☐ Transport fittings



A (Back Height) _____
 B (Arm Height) _____
 C (Lower Leg Length) _____
 D (Seat Depth) _____
 E (Chest Width) _____
 F (Seat Width) _____
 G (Height from Seat to Top of Head) _____
 H (Shoulder Width) _____
 Age _____
 Weight _____

Measurements

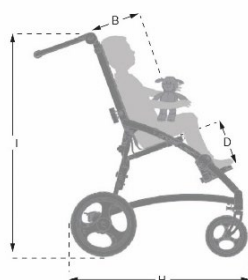

Size 1 Inches

Effective seat width (A) 13½"
 Effective seat depth (B) 8½"-12¼"
 Backrest height (C1) 19¾"
 Seat surface height at front edge (E) 19¾"-21"
 Footrest to seat distance (D) 7-14¼"
 Leg to seat surface angle 360°
 Backrest width, outside (F1) 13½"
 Backrest width, inside (F) 10¾"
 Overall width (G) 20¾"
 Length (H) 29½"
 Overall height (I) 39¼"
 Folded width 14"
 Folded height 19"
 Folding length 30"
 Backrest angle 110°-125°
 Minimum turning radius 27½"
 Total mass 27.3 lbs.
 Max load 77 lbs.
 Max load at transportation 59½ lbs.
 Required width of right angled corridor 32"
 Static stability (sideways, downhill, uphill) 10°



Size 2 Inches

15½"
 12¼"-17"
 22½"
 21¼"-22¼"
 8¾"-14½"
 360°
 15½"
 13
 22¾"
 29½"
 41¼"
 14"
 19"
 30"
 110°-125°
 30"
 29½ lbs.
 110 lbs.
 94½ lbs.
 32"
 10°

Notes:

Cricket Standard Features



- Back Recline
- Adjustable Seat Depth
- Height and Angle Adjustable Foot Support
- Armrest, Fixed (Pr.)
- Angle Adjustable Pushbrace
- Foot Operated Wheel Lock
- Castors - 7" Front 11" Rear Solid

Description	Part No.	HCPCS
<input type="checkbox"/> Cricket sz 1	87043100	E1236
<input type="checkbox"/> Cricket sz 2	87043200	E1236

Description	Size	Part No.	HCPCS
-------------	------	----------	-------

Required, must select a color

- ☐ Blue = 1 ☐ Red = 2
☐ Pink = 5 ☐ Grey = 4

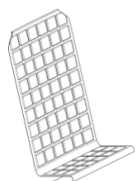

- ☐ Cushion 1 8704311x
☐ Cushion 2 8704321x

♦ Colors Green, Orange & Yellow available as a custom order; Approx. lead time: 6-8 weeks. Non-returnable item

- ☐ Seat Side Parts ♦ One Size 87043130

♦ Required with Seat Width Reduction Kit



Description	Measurements	Size	Part No.	HCPCS
<input type="checkbox"/> Transit Option		One Size	87043188	

Description	Measurements	Size	Part No.	HCPCS
<input type="checkbox"/> Armrest, Fixed (Pr.) ♦		1	87043120-1	
<input type="checkbox"/> Armrest, Fixed (Pr.) ♦		2	87043120-2	

♦ Required with Grip Bar, In Armrests



Description	Measurements	Size	Part No.	HCPCS
<input type="checkbox"/> Seat Width Reduction Kit, Wedges (Pr.) ♦			87043130-1	K0108
<input type="checkbox"/> Seat Width Reduction Kit, Wedges (Pr.) ♦			87043130-2	K0108

♦ Requires Seat Side Parts (87043130)



- ☐ Wedges for Shaping Back (Pr.) 4½" x 6" x 11" Type 1 87043140-1 K0108
☐ Wedges for Shaping Back (Pr.) 5¾" x 6" x 11" Type 2 87043140-2 K0108

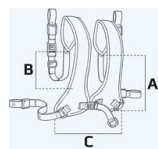

- ☐ Chest Belt, Upholstery (Ea.) A:11¼ x B:7½ x C:9¼-12" 1 85428-1 E0960
☐ Chest Belt, Upholstery (Ea.) A:14 x B:10 x C:10-12¾" 2 85428-2 E0960

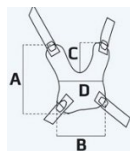

- ☐ Neoprene Vest (Ea.) A:7 x B:5½ x C:4 x D:4½" 1 89113-1 E0960
☐ Neoprene Vest (Ea.) A:10½ x B:11 x C:6½ x D:5¾" 2 89113-2 E0960

Accessories	Description	Measurements	Size	Part No.	HCPCS
-------------	-------------	--------------	------	----------	-------

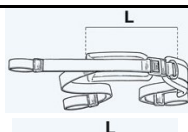

- ☐ 2-Point Pelvic Belt, Black L: 13-14½" 1 85424-1 E0978

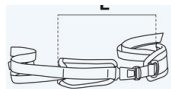

<input type="checkbox"/> 4-Point Padded Hip Belt	L: 10¼-11½"	1	85427-1	E0978
<input type="checkbox"/> 4-Point Padded Hip Belt	L: 12½-13½"	2	85427-2	E0978



<input type="checkbox"/> Fix-Locks, Black, Bag of 6 Pcs ♦	One Size	862109-35		
---	----------	-----------	--	--

♦ **Required for use of Vests**

Description	Measurements	Size	Part No.	HPCPS
<input type="checkbox"/> Pelvic Harness	A: 6½ x B: 7½"	0	89108-0	E0978
<input type="checkbox"/> Pelvic Harness	A: 8½ x B: 8¾"	1	89108-1	E0978
<input type="checkbox"/> Pelvic Harness	A: 10½ x B: 9¾"	2	89108-2	E0978

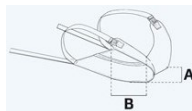

<input type="checkbox"/> Heel Straps (Pr.)	One Size	87043185		E0951
--	----------	----------	--	-------

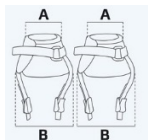

<input type="checkbox"/> Upholstered Ankle Straps	A: 5½-7 x B: 8½-10"	1	85426-1	K0108
<input type="checkbox"/> Upholstered Ankle Straps	A: 6¼-7¾ x B: 10-11¾"	2	85426-2	K0108

Other types of vests and belts available, please see Vest and Belts Order Form

Description	Measurements	Size	Part No.	HPCPS
-------------	--------------	------	----------	-------



<input type="checkbox"/> Headrest Cushion, Black (Ea.)	One Size	87043150		E0955
--	----------	----------	--	-------



<input type="checkbox"/> Sculpted Headrest Cushion, Black (Ea.)	One Size	87043151		E0955
---	----------	----------	--	-------

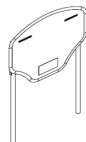

<input type="checkbox"/> Backrest Height Extension (Ea.)	1	87043160-1		K0108
<input type="checkbox"/> Backrest Height Extension (Ea.)	2	87043160-2		K0108

Description	Measurements	Size	Part No.	HPCPS
-------------	--------------	------	----------	-------

<input type="checkbox"/> Calf Support Strap (Ea.)	1	87043190-1		E0995
<input type="checkbox"/> Calf Support Strap (Ea.)	2	87043190-2		E0995

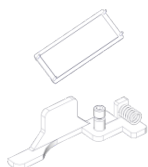

<input type="checkbox"/> Additional Footplate Locking Mechanism (Ea.)	One Size	87043186		
---	----------	----------	--	--



<input type="checkbox"/> Grip Bar, In Armrests ♦	1	87043181-1		
<input type="checkbox"/> Grip Bar, In Armrests ♦	2	87043181-2		

♦ **Requires Armrest**



<input type="checkbox"/> Grip Bar, In Frame	1	87043182-1		
<input type="checkbox"/> Grip Bar, In Frame	2	87043182-2		



<input type="checkbox"/> Caster Locks	One Size	87043187		K0073
---------------------------------------	----------	----------	--	-------

Accessories	Description	Measurements	Size	Part No.	HPCPS
-------------	-------------	--------------	------	----------	-------



Required, must select a color

x = Color

<input type="checkbox"/> Blue = 1	<input type="checkbox"/> Red = 2
<input type="checkbox"/> Pink = 5	<input type="checkbox"/> Grey = 4

<input type="checkbox"/> Folding Top (Canopy) (Ea.) ♦	1	8704317x		
<input type="checkbox"/> Folding Top (Canopy) (Ea.) ♦	2	8704327x		

♦ **Required w/ Rain Cover**



- ☐ Underseat Storage Basket ♦
 - ☐ Underseat Storage Basket ♦
- ♦ **22 lbs. weight limit**

1 87043184-1
2 87043184-2



- ☐ Tray ♦
 - ☐ Tray ♦
- ♦ **Must select same size as armrest**

1 87043180-1 E0950
2 87043180-2 E0950



- ☐ Storage Strap

One Size 85100



- ☐ Rain Cape with Hood, Clear A:11 x B:29½"
- ☐ Rain Cape with Hood, Clear A:11½ x B:34½"

4 87465-410
5 87465-510

- ☐ Rain Cover, Clear (Ea.) ♦
 - ☐ Rain Cover, Clear (Ea.) ♦
- ♦ **Requires Folding Top (Canopy)**

2 87467-210
3 87467-310

HCPCS codes are provided for your convenience and are NOT to be considered billing or legal advice. Providers are responsible for insuring that all appropriate billing codes are used when submitting claims. Proper use of HCPCS codes does not insure coverage or payment. Contact the appropriate payer for coverage information.

The Cricket complies with ISO7176-19, for safe transportation in motor vehicles. The R82 Cricket was tested with the Cricket back rest height extension and Y-hip belt and R82 transit anchors. The performance and safety of accessories and/or other seating options not tested by R82 is unknown, and no warranty or claim about their performance is or can be made.

When being transported in a vehicle, it is R82's position that the wheelchair user transfer from the wheelchair into appropriate vehicle seating during transportation. Please note that at this time, the Department of Transportation has not officially approved any tie-down system for a user while in a wheelchair; therefore R82 cannot recommend a transit system.