



GEMINO

100% ROLLATORS





GEMINO 30

THE ORIGINAL 100% ROLLATOR

// LIFE IS COLOURFUL

Are you looking for individuality? Express your personality with a selection of 4 attractive anodized frame colours.

Silver grey



Champagne



Midnight blue



Pink



// ADVANCED BAGS TO MIX AND MATCH

Compliment your Gemini 30 with a stylish and practical bag with shoulder strap.



GEMINO 60



// WHEELS THAT MAKE THE DIFFERENCE

The extra-large, soft wheels allow you to negotiate virtually any obstacle with ease. And ensure ultimate walking comfort – on any surface.



// DESIGNED FOR SUPERIOR STABILITY

The GEMINO 60's sturdy, extra wide and long frame together with the large wheels ensure excellent stability and safety, also on rough terrain.



// ENJOY MORE SPACE

The large wheelbase makes for maximum stability, whilst offering extra walking space and a very spacious seat – also available with adjustable comfort back support. Great if you want to take a break.



// EASILY HANDLING EXTRA WEIGHT

All GEMINO 60 models are suitable for heavy-duty use and take a maximum user weight of 150 kg. Lots of things to carry? The extra strong basket carries up to 10 kg.



GEMINO 30 walker



EXTRA SUPPORT AND STABILITY. ALSO GREAT FOR GAIT TRAINING

If you need extra support when walking, the **Gemino 30 Walker** is the perfect choice for you. This lightweight rollator is fitted with fully adjustable forearm supports, enabling you to walk comfortably and securely. The integrated push handles and brakes are easy to reach and very light to operate. Combining the benefits of the **Gemino 30** with enhanced support and stability makes the **Gemino 30 Walker** also ideal for gait training.

//FOREARM SUPPORTS FOR ENHANCED STABILITY AND SAFETY

You can easily adjust the height, depth and angle of the forearm supports to suit your needs. The brakes and push handles are fully integrated – easy to reach and light to operate. For comfortable and safe walking.

//ADVANCED BRAKING OPTIONS FOR EVEN MORE SECURITY

Looking for even more security? Complement your Gemino 30 Walker with a slowdown brake or innovative SpeedControl braking system. With SpeedControl your rollator will brake automatically when you start to accelerate. You'll keep an upright posture and walk confidently and comfortably close to your rollator.



OPTIMAL SUPPORT AND STABILITY – INDOORS AND OUT

Going out a lot? With the Gemino 60 Walker you get the best of both worlds: The comfortable rolling characteristics and stability of the Gemino 60 and the additional support and safety you'd expect from a 'walker'. Adjust the forearm supports and push handles to fit your needs, and enjoy more freedom indoors - and outdoors. Naturally, you can also use this lightweight rollator for extended gait training!

// ADJUSTABLE FOREARM SUPPORTS FOR ENHANCED STABILITY

The forearm supports with integrated push handles and brakes are designed for optimal support and stability, and easy use. Adjust to suit your height and enjoy a comfortable walking position.

// COMFORTABLE AND SAFE OUTDOOR USE

The sturdy frame design coupled with extra-large soft wheels allow you to go out in total comfort and safety. Cobble streets or thresholds in your home? With the Gemino 60 Walker you'll overcome any obstacle with ease.



GEMINO 60 walker



GEMINO 30

parkinson



SPECIALLY DESIGNED FOR PEOPLE WITH PARKINSON'S

Some people need a little extra help to be able to walk safely. If you've Parkinson's disease, you may be one of those people. Our **Gemino 30 Parkinson** rollator has been developed with you in mind and offers features that are fully tailored to your particular needs. Get out and about safely – and with confidence!

// SLOWDOWN BRAKE PROMOTES A STEADY PACE

The Gemino 30 Parkinson is fitted with a slowdown brake, which provides additional resistance and helps you walk at a steady pace. Adjust the level of resistance to your specific needs.

// INCREASED SAFETY WITH REVERSE BRAKE

Due to the reverse braking system the rollator immediately stops moving once the brake is released. This increases safety if you experience 'freezing' while walking - when it feels like your feet are glued to the ground.

// LASER DEVICE HELPS OVERCOME FREEZING

When 'freezing' occurs, you can activate a laser line with a button on the push handles. Through concentrating on the line that appears on the ground, you can then step over it and get moving again.



100% CHOICE

PRACTICAL ACCESSORIES FOR YOU

Gemino rollators are not just easily adjustable. They also come with a full range of attractive accessories to make everyday life easier. A stylish bag, a practical crutch holder, a comfortable back support or a light for extra safety? Choose the options that fit your needs and lifestyle!

// COLOURFUL ADVANCED BAGS

Compliment your Gemino with a stylish, closable bag in your favourite colour. With handles and shoulder strap for easy carrying.

Not available for Gemino 60 M



// BAGS FOR GEMINO 30 S





// UMBRELLA

Rainy weather conditions? With this height-adjustable umbrella you can go out safely, as you can keep both hands on the push handles.

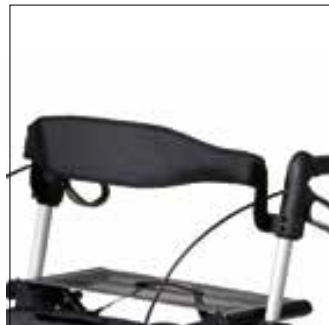

// BACK SUPPORT*

Provides you support to sit comfortably and safely when it's time to take a break. No need to remove when folding the rollator.



// ADJUSTABLE COMFORT BACK SUPPORT**

For additional comfort, choose this large, softly padded back support. Quick to adjust, easily folds with the rollator.



// TABLE TRAY

Practical tray with cup holder allows you to transport food and beverages safely and with ease.



// CRUTCH HOLDER

Keeps your crutch or walking cane securely fastened when walking. Easy to mount, easy to access.



// BASKET FOR OXYGEN CYLINDER***

Carrier bag with shoulder strap for safe transport of oxygen cylinders.



// LIGHT

Ensures you're well visible in the dark – for additional safety.



// INFUSION HOLDER

Height and angle adjustable drip holder.

* check availability per model ** not available for Gemino 30/30 M

Walker *** not available for Gemino 60 M.

GEMINO - SELECTION GUIDE



GEMINO 20

Light-weight design rollator. Great functionality at an attractive price



Indoor and outdoor use

Everyday use



331 lbs.
287 lbs. (M)
276 lbs. (S)



59" - 79"
53" - 67" (M)
49" - 65" (S)
Also suitable for children



GEMINO 30

Our original 100% rollator. Award-winning design combining high indoor maneuverability with outdoor performance. Lots of colour options and accessories for easy customization.



Use indoors and out, mainly in the city

Everyday use



331 lbs.
287 lbs. (M)
276 lbs. (S)



59" - 79"
53" - 67" (M)
49" - 65" cm (S)
Also suitable for children



Small turning radius for great indoor maneuverability

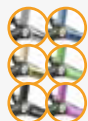

Easy personalization with frame colours and bag colours.
Wide range of accessories



GEMINO 60

Designed for any kind of terrain and heavy-duty use. Lightweight, yet rock-solid. All the benefits of the award-winning Gemino 30 and more.



Mostly outdoor use, also on rugged terrain, occasionally indoors

Active / heavy-duty use



331 lbs.
331 lbs. (M)



59" - 79"
53" - 67" (M)



Extra wide and long frame for ultimate stability



Extra-large and soft wheels ensure ultimate comfort and easy negotiation of any obstacle



Extra wide seat



Extra strong bag (22 lbs. load capacity)





GEMINO 30 walker

Lightweight walker with adjustable forearm supports. The perfect companion if you need extra support and stability indoors. Also great for gait training.



Indoor use

Everyday use /
gait training



331 lbs.
286 lbs. (M)



59" - 79"
53" - 67" (M)



Height-adjustable forearm
supports for extra support
and stability



GEMINO 60 walker

Optimal support and stability – indoors and out. Combines the comfortable rolling characteristics and stability of the Gemino 60 with the additional support and safety you'd expect from a walker.



Indoor and outdoor use,
also on uneven terrain

Everyday use / gait training



286 lbs.
286 lbs. (M)



59" - 79"
53" - 67" (M)



Height-adjustable forearm
supports for extra support
and stability



Extra wide and long frame
for ultimate stability



Extra-large and soft wheels
ensure ultimate comfort
and easy negotiation of any
obstacle



Extra strong bag (22 lbs.
load capacity)



GEMINO 30 parkinson

Specially designed for people with Parkinson's. Featuring a slowdown brake promoting a steady pace, and a reverse braking system and laser light to help with 'freezing'.



Use indoors and out,
mainly in the city

Everyday use



286 lbs.
286 lbs. (M)



59" - 79"
53" - 67" (M)



Small turning radius
for great indoor
maneuverability



Reverse braking system:
the rollator immediately
stops moving once the
brake is released



Slowdown brake provides
extra resistance and
promotes a steady pace



Laser light can be activated
to help overcome 'freezing'



GEMINO TECHNICAL DATA

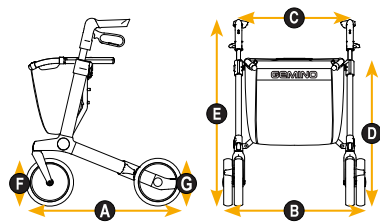

| | | GEMINO 20 | | | GEMINO 30 | | | GEMINO 60 | |
|---|------|-------------|-------------|-----------|-------------|-------------|-----------|-------------|-------------|
| | | 20 | 20M | 20S | 30 | 30M | 30S | 60 | 60M |
| DIMENSIONS | | | | | | | | | |
| Maximum user weight | lbs. | 331 | 287 | 276 | 331 | 287 | 276 | 331 | 331 |
| Recommended user height | in | 59 - 79 | 53 - 67 | 49 - 65 | 59 - 79 | 53 - 67 | 49 - 65 | 59 - 79 | 53 - 67 |
| Maximum load capacity in basket | lbs. | 11 | 11 | 11 | 11 | 11 | 11 | 22 | 22 |
| Total length A | in | 26 | 26 | 27 | 26 | 26 | 27 | 29 | 29 |
| Total width B | in | 24 | 24 | 22 | 24 | 24 | 22 | 25 | 25 |
| Total weight without basket (with basket) | lbs. | 15.7 (16.3) | 15.4 (16.1) | 14.5 (15) | 15.7 (16.3) | 15.4 (16.1) | 14.5 (15) | 18.7 (19.4) | 18.1 (18.7) |
| Width between centre of push handles C | in | 19 | 19 | 17 | 19 | 19 | 17 | 20 | 20 |
| Seat height D | in | 24 | 22 | 19 | 24 | 22 | 19 | 24 | 21 |
| Total height E | in | 31 - 39 | 27 - 35 | 26 - 30 | 31 - 39 | 27 - 35 | 26 - 30 | 30 - 37 | 29 - 33 |
| Total height folded | in | 31 | 30 | 27 | 31 | 30 | 27 | 33 | 31 |
| Total length folded | in | 26 | 26 | 27 | 26 | 26 | 27 | 29 | 29 |
| Total width folded | in | 9 | 9 | 9 | 9 | 9 | 9 | 9 | 9 |
| Diameter front wheels F | in | 8 x 1.4 | 8 x 1.4 | 8 x 1.4 | 8 x 1.4 | 8 x 1.4 | 8 x 1.4 | 11 x 1.7 | 11 x 1.7 |
| Diameter rear wheels G | in | 8 x 1.4 | 8 x 1.4 | 8 x 1.4 | 8 x 1.4 | 8 x 1.4 | 8 x 1.4 | 9 x 1.7 | 9 x 1.7 |
| PERFORMANCE | | | | | | | | | |
| Turning radius | in | 33 | 33 | 31 | 33 | 33 | 31 | 37 | 37 |
| COLOUR OPTIONS | | | | | | | | | |
| Grey | | ✓ | ✓ | ✓ | | | | | |
| Silver grey | | | | | ✓ | ✓ | ✓ | ✓ | ✓ |
| Champagne | | | | | ✓ | ✓ | | | |
| Midnight blue | | | | | ✓ | ✓ | ✓ | | |
| Pink | | | | | ✓ | | ✓ | | |
| CERTIFICATES | | | | | | | | | |
| CE | | ✓ | ✓ | ✓ | ✓ | ✓ | ✓ | ✓ | ✓ |
| EN 12182 | | ✓ | ✓ | ✓ | ✓ | ✓ | ✓ | ✓ | ✓ |
| ISO 11199-2 | | ✓ | ✓ | ✓ | ✓ | ✓ | ✓ | ✓ | ✓ |
| ISO 11199-3 | | | | | | | | | |



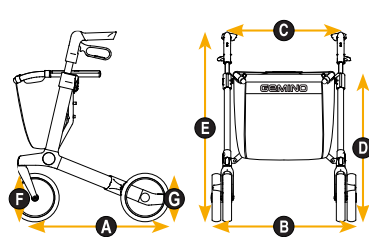

| | | GEMINO 30 walker | | GEMINO 60 walker | | GEMINO 30 parkinson | |
|---|------|------------------|-------------|------------------|-------------|---------------------|-----------|
| | | 30 | 30M | 60 | 60M | 30 | 30M |
| DIMENSIONS | | | | | | | |
| Maximum user weight | lbs. | 331 | 287 | 287 | 287 | 287 | 287 |
| Recommended user height | in | 59 - 79 | 53 - 67 | 59 - 79 | 53 - 67 | 59 - 79 | 53 - 67 |
| Maximum load capacity in basket | lbs. | 11 | 11 | 22 | 22 | 11 | 11 |
| Total length A | in | 26 | 26 | 29 | 29 | 26 | 26 |
| Total width B | in | 24 | 24 | 25 | 25 | 24 | 24 |
| Total weight without basket (with basket) | lbs. | 23.4 (24) | 22.9 (23.6) | 26 (26.7) | 25.6 (26.2) | 16.5 (17.2) | 16.3 (17) |
| Width between centre of push handles C | in | 10 | 10 | 13 | 13 | 19 | 19 |
| Seat height D | in | 24 | 22 | 24 | 21 | 24 | 22 |
| Total height E | in | 39 - 44 | 33 - 39 | 39 - 46 | 35 - 39 | 31 - 39 | 27 - 35 |
| Total height folded | in | 38 | 35 | 43 | 40 | 32 | 30 |
| Total length folded | in | 10 | 10 | 11 | 11 | 10 | 10 |
| Total width folded | in | 14 | 14 | 14 | 14 | 9 | 9 |
| Diameter front wheels F | in | 11 x 1.4 | 11 x 1.4 | 11 x 1.7 | 11 x 1.7 | 11 x 1.4 | 11 x 1.4 |
| Diameter rear wheels G | in | 11 x 1.4 | 11 x 1.4 | 9 x 1.7 | 9 x 1.7 | 11 x 1.4 | 11 x 1.4 |
| PERFORMANCE | | | | | | | |
| Turning radius | in | 33 | 33 | 37 | 37 | 33 | 33 |
| COLOUR OPTIONS | | | | | | | |
| Grey | | | | | | | |
| Silver grey | | ✓ | ✓ | ✓ | ✓ | ✓ | ✓ |
| Champagne | | | | | | | |
| Midnight blue | | | | | | | |
| Pink | | | | | | | |
| Apple green | | | | | | | |
| Black | | | | | | | |
| CERTIFICATES | | | | | | | |
| CE | | ✓ | ✓ | ✓ | ✓ | ✓ | ✓ |
| EN 12182 | | ✓ | ✓ | ✓ | ✓ | ✓ | ✓ |
| ISO 11199-2 | | | | | | ✓ | ✓ |
| ISO 11199-3 | | ✓ | ✓ | ✓ | ✓ | | |

For further information on the full specification, options and accessories, please refer to the order form.
All information is subject to change without notification. Please consult Sunrise Medical with any queries you may have.

